

Retaining system is composed of a 1.25# homogeneous expanded polystyrene. Yield strength of EPS is 22-25 psi, but system was designed to keep tensile and compression stress below 4 psi to keep strain less than 1%.

Face of retaining wall can be finished with many different cladding materials, such as steel, architectural metal, wood, etc. The face of retaining wall can be plastered or a veneer stone or brick can be applied. Multiple top caps can be bonded to the top of the foam for many design options.

2-3.5' Tall Retaining system(available in 6" increments)

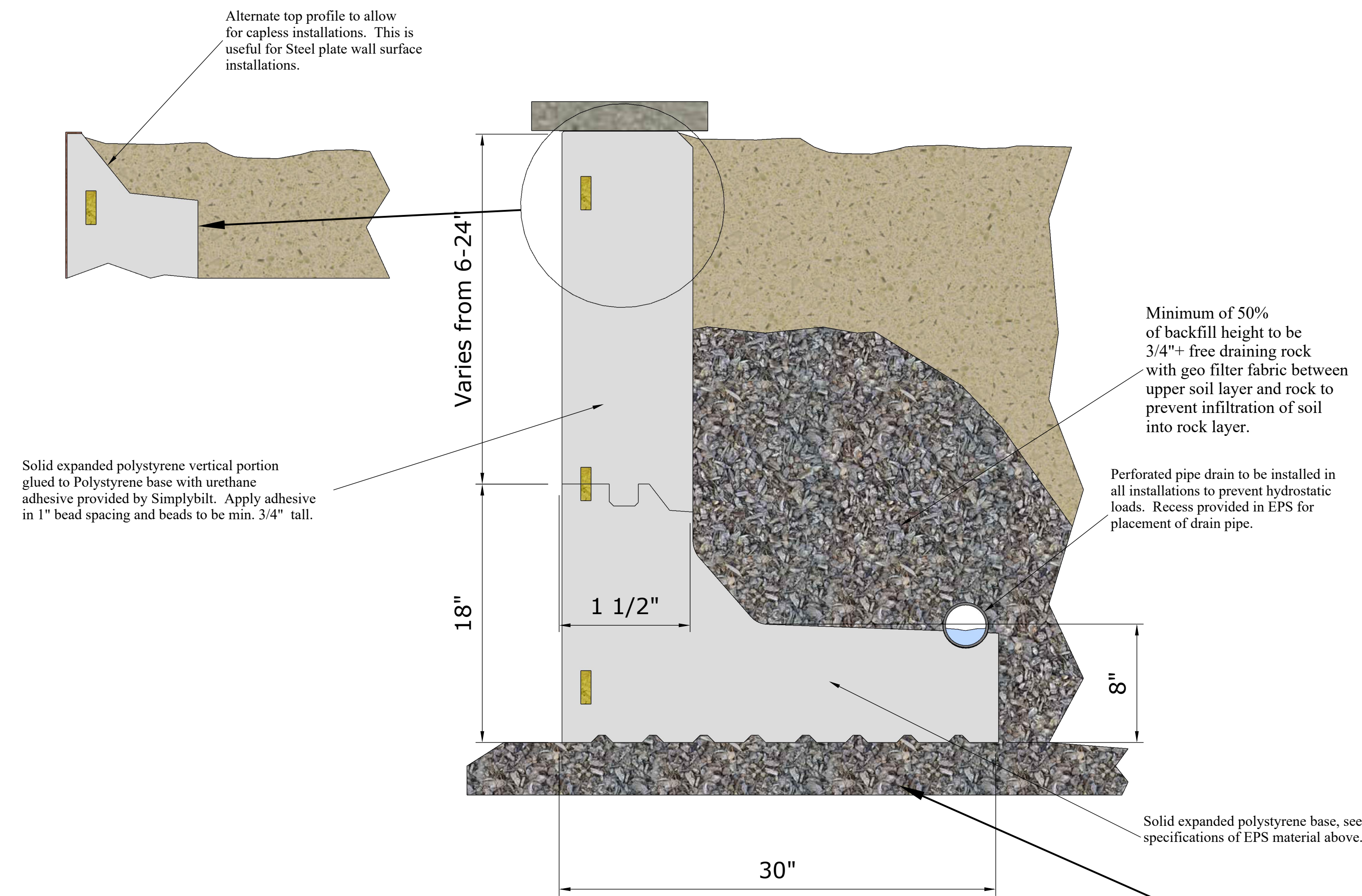

4-6' Tall Retaining system(available in 12" increments)

